**St. Pancras
Campus.**

Maker space

**Versatile spaces.
Built for performance.**

**23,000 sq ft of light industrial units
Now available**

St. Pancras Campus.

Welcome to St. Pancras Campus.

A new destination where innovative businesses will thrive, with 20,000 sq ft dedicated to light industrial enterprises. The building design champions sustainability, and the abundant occupier amenities nurture wellness and a true sense of community.

01 Introduction

02 Location

03 Maker space

04 Contact



Introduction

The centre of ideas and innovation.

St. Pancras Campus sits within Camden's creative district and is part of the dynamic commercial energy of King's Cross.

Experience a neighbourhood where creativity thrives and innovation drives progress — in an environment that inspires ideas, sparks creativity, and fosters meaningful connections.



- 01** Introduction
- 02 Location
- 03 Maker space
- 04 Contact

Introduction

The centre of ideas and innovation.

St. Pancras Campus sits within Camden's creative district and is part of the dynamic commercial energy of King's Cross.

Experience a neighbourhood where creativity thrives and innovation drives progress — in an environment that inspires ideas, sparks creativity, and fosters meaningful connections.



- 01 Introduction
- 02 Location
- 03 Maker space
- 04 Contact

Introduction

Enrich the workday with world- class amenities.

With wellbeing in mind, campus life is enriched by an impressive collection of occupier amenities, including outdoor spaces, meeting and eating places, and best-in-class facilities for green commuters.



Pavilion



Co-working space



Communal terrace



Campus café



Commuter facilities



Pocket park

- 01 Introduction
- 02 Location
- 03 Maker space
- 04 Contact

St. Pancras Campus.

Local Occupiers

The destination for global innovators.

St. Pancras Campus lies within London's Knowledge Quarter. This rapidly developing part of the capital has firmly established itself as a hub for global businesses. A location for businesses looking for a stimulating place to grow.



- 01 Introduction
- 02 Location**
- 03 Maker space
- 04 Contact

St. Pancras Campus.

Transport

Empowered by excellent connections.

A well-connected location with Camden Town Station just minutes away — a starting point for effortless cross-city travel with local, national, and international transport connections.



Connections



| | | |
|-----------------------------|--|--------|
| Camden Road | | 3 min |
| Camden Town | | 7 min |
| King's Cross St. Pancras | | 15 min |
| Euston | | 18 min |

- 01 Introduction
- 02 Location**
- 03 Maker space
- 04 Contact

Amenity

A hub for social and cultural amenities.

| ● Food and drink | 🚶 |
|-------------------------|--------|
| 1. Prince Albert | 1 min |
| 2. The Golden Lion | 1 min |
| 3. The Constitution pub | 2 min |
| 4. Casa Tua | 3 min |
| 5. Pritchard & Ure | 3 min |
| 6. The Living Room Café | 4 min |
| 7. Blank Street Coffee | 6 min |
| 8. Camden Bakery | 6 min |
| 9. Jazz Café | 7 min |
| 10. Boxpark | 9 min |
| 11. Cafe KOKO | 9 min |
| 12. KOKO | 10 min |
| 13. Hawley Wharf | 10 min |
| 14. Camden Market | 11 min |
| 15. Mare Street Market | 12 min |
| 16. Lina Store | 15 min |
| 17. Barrafinna | 15 min |
| 18. Dishoom | 15 min |
| 19. German Gymnasium | 16 min |

| ● Retail and leisure | 🚶 | ● Lifestyle | 🚶 |
|----------------------|--------|-----------------------|--------|
| 1. COS | 14 min | 1. F45 Training | 4 min |
| 2. Rains | 15 min | 2. Pure Gym | 8 min |
| 3. Aēsop | 16 min | 3. More Yoga | 9 min |
| 4. Uniqlo | 16 min | 4. Ten Health Fitness | 12 min |
| 5. Everyman Cinema | 17 min | | |

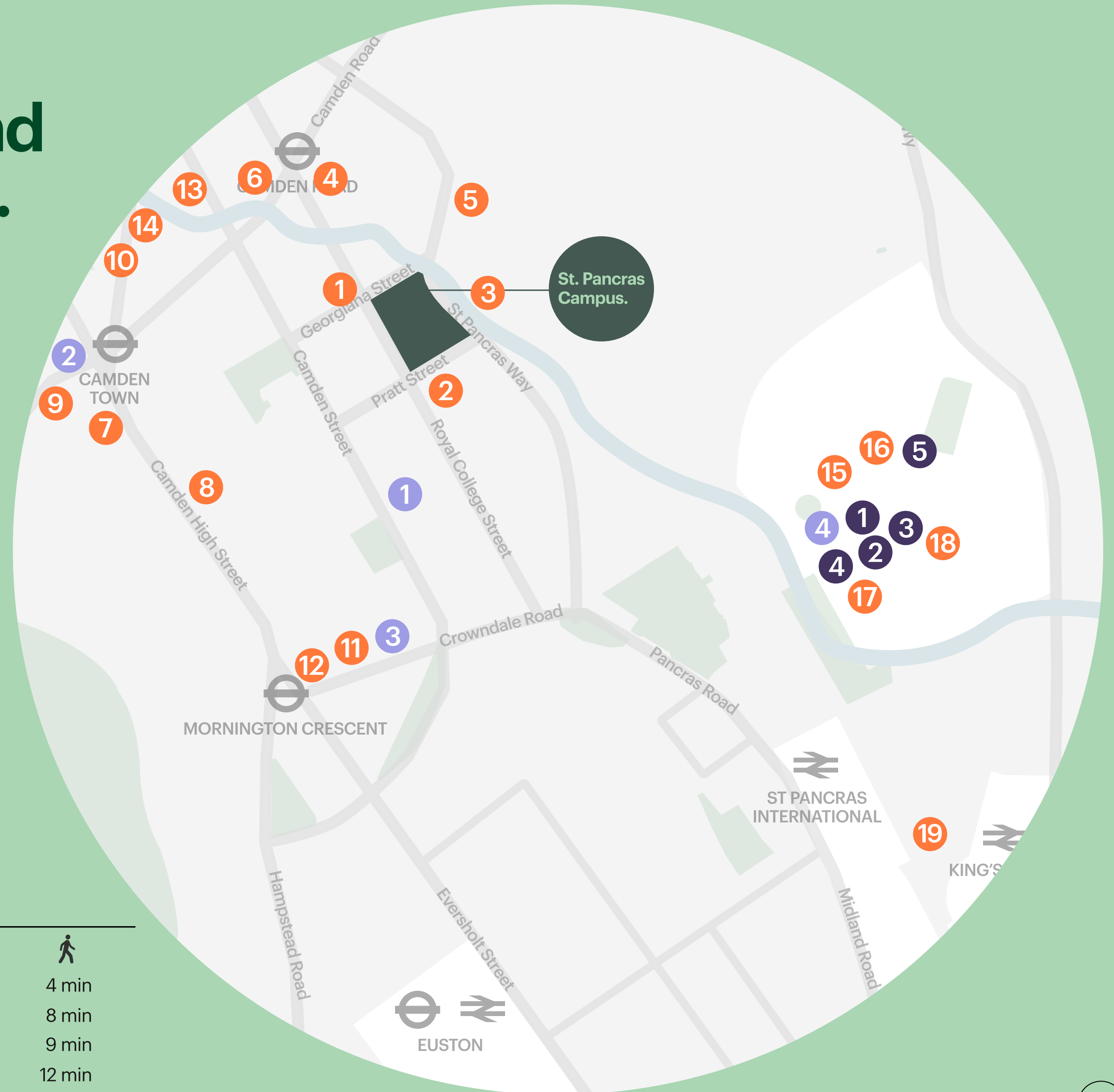

- 01 Introduction
- 02 Location**
- 03 Maker space
- 04 Contact

St. Pancras Campus.



Coal Drops Yard 10 min



Hawley Wharf 10 min

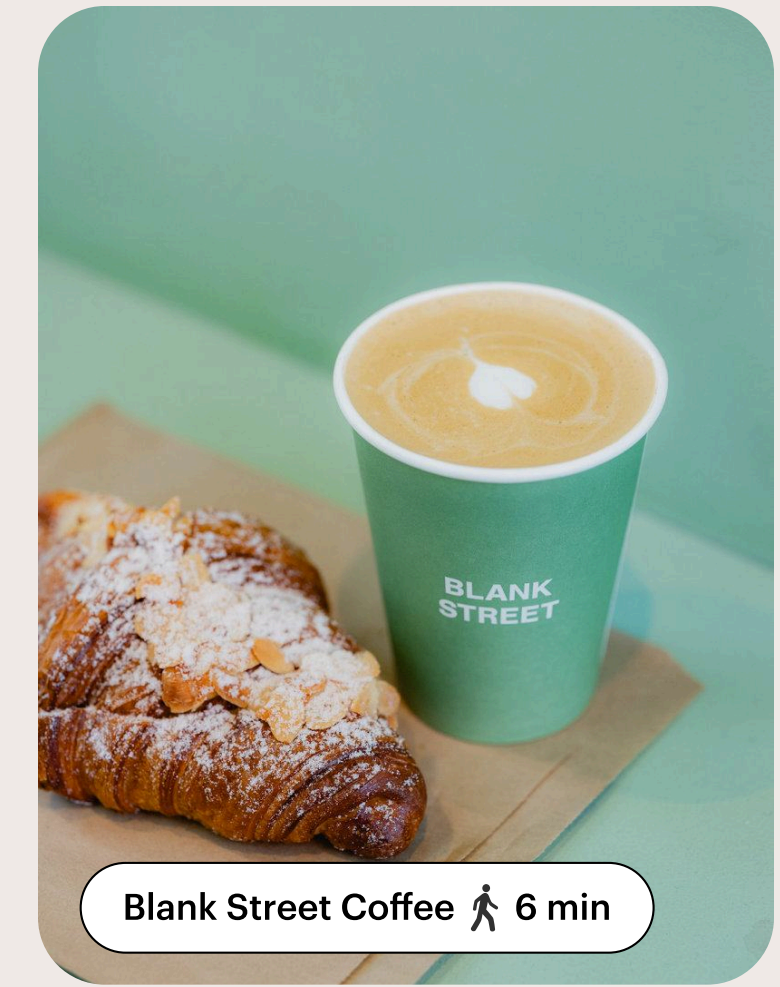

Blank Street Coffee 6 min



Everyman cinema 17 min



Camden Market 11 min



Camden Bakery 6 min



Cafe KOKO 9 min

- 01 Introduction
- 02 Location**
- 03 Maker space
- 04 Contact

Maker space Availability

2 3 4

The light-industrial units make St. Pancras Campus a dynamic hub for innovators and makers. The spaces are versatile and highly functional, with vast floor-to-ceiling heights, easily accessible loading bays, and secure parking.

| Unit | sq ft |
|----------|-------|
| ● Unit 2 | 4,250 |
| ● Unit 3 | 8,729 |
| ● Unit 4 | 6,945 |
| ● Unit 5 | 2,965 |

- 01 Introduction
- 02 Location
- 03 Maker space**
- 04 Contact



Maker space Specification

+ Substantial load capacity (up to 30kN/ms)

+ Option to interconnect units

+ Direct delivery access

+ Dedicated car parking

+ Loading facilities

+ Goods lift access

+ 501kVA power supply

+ Option for shop front (on St Pancras Way)

- 01 Introduction
- 02 Location
- 03 Maker space**
- 04 Contact



Maker unit Floorplan

2

Floor to ceiling heights:
(floor to underside of structure)

Ground: 4.23 m
Basement: 4.60 m

| Unit | sq ft |
|------------------------------|--------------|
| Unit 2: | |
| Mezzanine | -- |
| Ground | 1,662 |
| Basement | 2,558 |
| Total: | 4,250 |
| <input type="radio"/> Unit 3 | 8,729 |
| <input type="radio"/> Unit 4 | 6,945 |
| <input type="radio"/> Unit 5 | 2,965 |

- 01 Introduction
- 02 Location
- 03 Maker space**
- 04 Contact

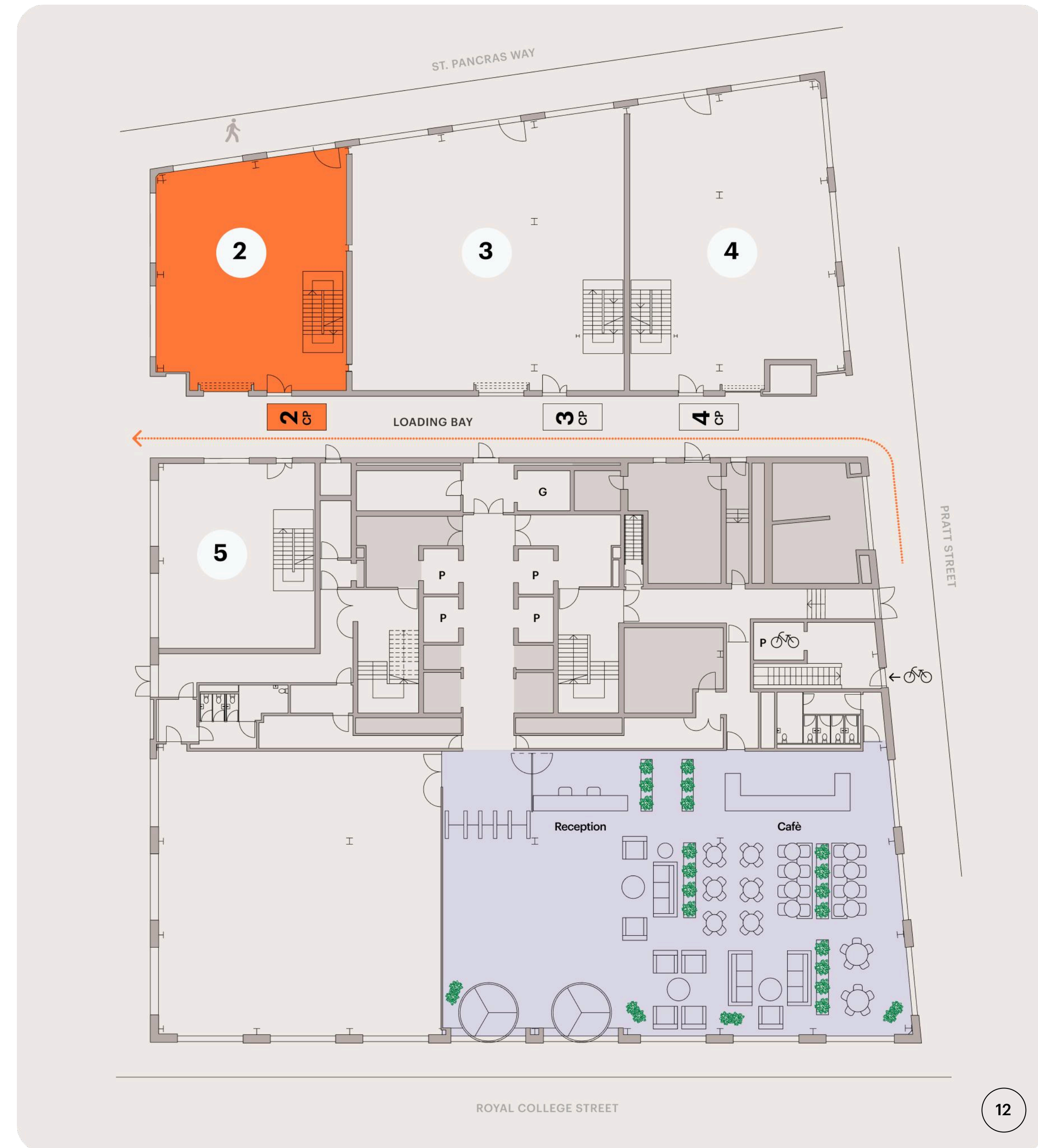

Maker unit Floorplan

3

Floor to ceiling heights:
(floor to underside of structure)

Ground: 4.80 m
Basement: 3.55 m

| Unit | sq ft |
|---|--------------|
| <input type="radio"/> Unit 2 | 4,250 |
| <input checked="" type="radio"/> Unit 3: | |
| Mezzanine | 1,692 |
| Ground | 2,907 |
| Basement | 4,130 |
| Total: | 8,729 |
| <input type="radio"/> Unit 4 | 6,945 |
| <input type="radio"/> Unit 5 | 2,965 |

- 01 Introduction
- 02 Location
- 03 Maker space**
- 04 Contact

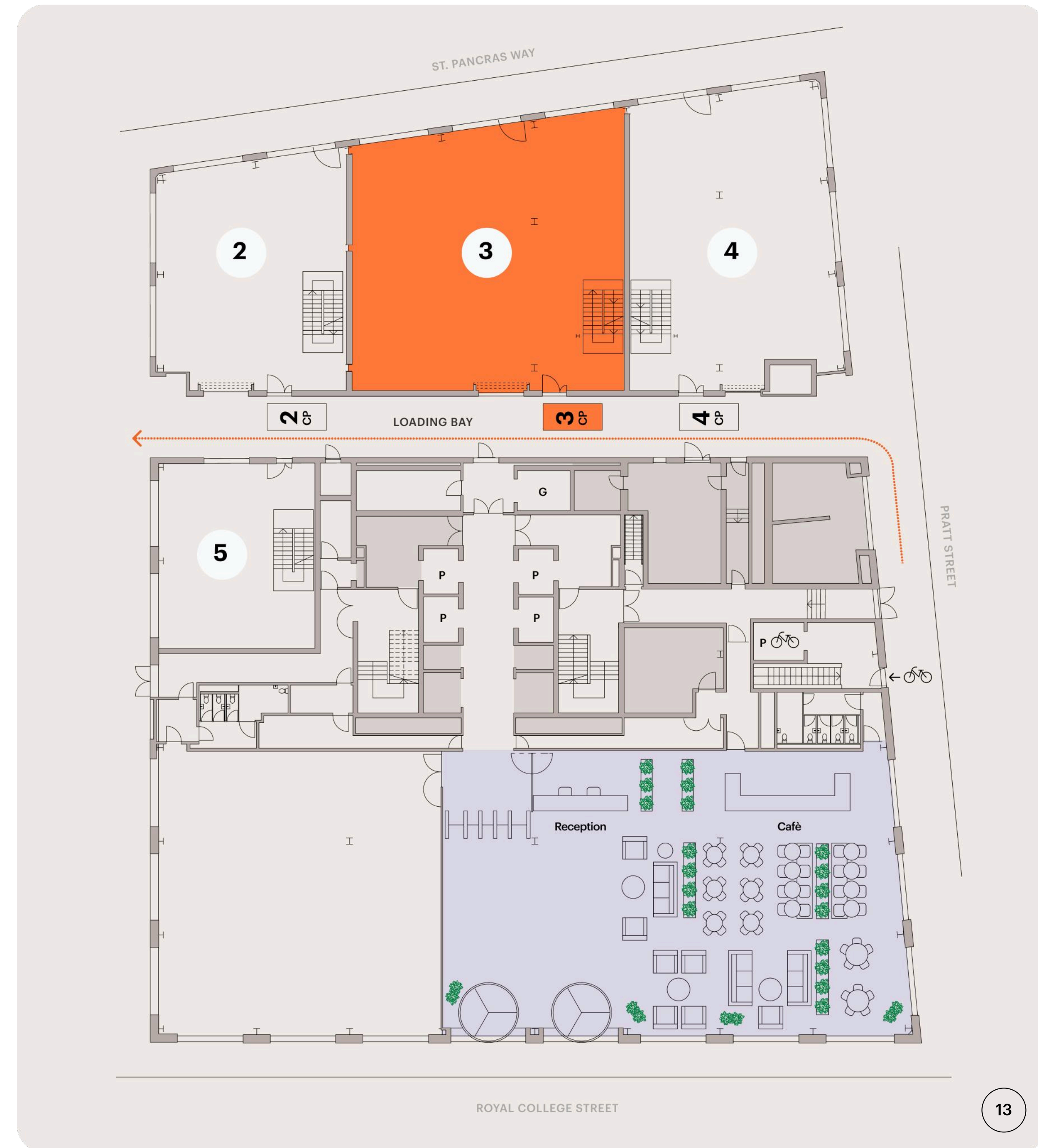

Maker unit Floorplan

4

Floor to ceiling heights:
(floor to underside of structure)

Ground: 5.22 m
Basement: 3.55 m

| Unit | sq ft |
|------------------|--------------|
| ○ Unit 2 | 4,250 |
| ○ Unit 3 | 8,729 |
| ● Unit 4: | |
| Mezzanine | 1,482 |
| Ground | 2,331 |
| Basement | 3,132 |
| Total: | 6,945 |
| ○ Unit 5 | 2,965 |

- 01 Introduction
- 02 Location
- 03 Maker space**
- 04 Contact

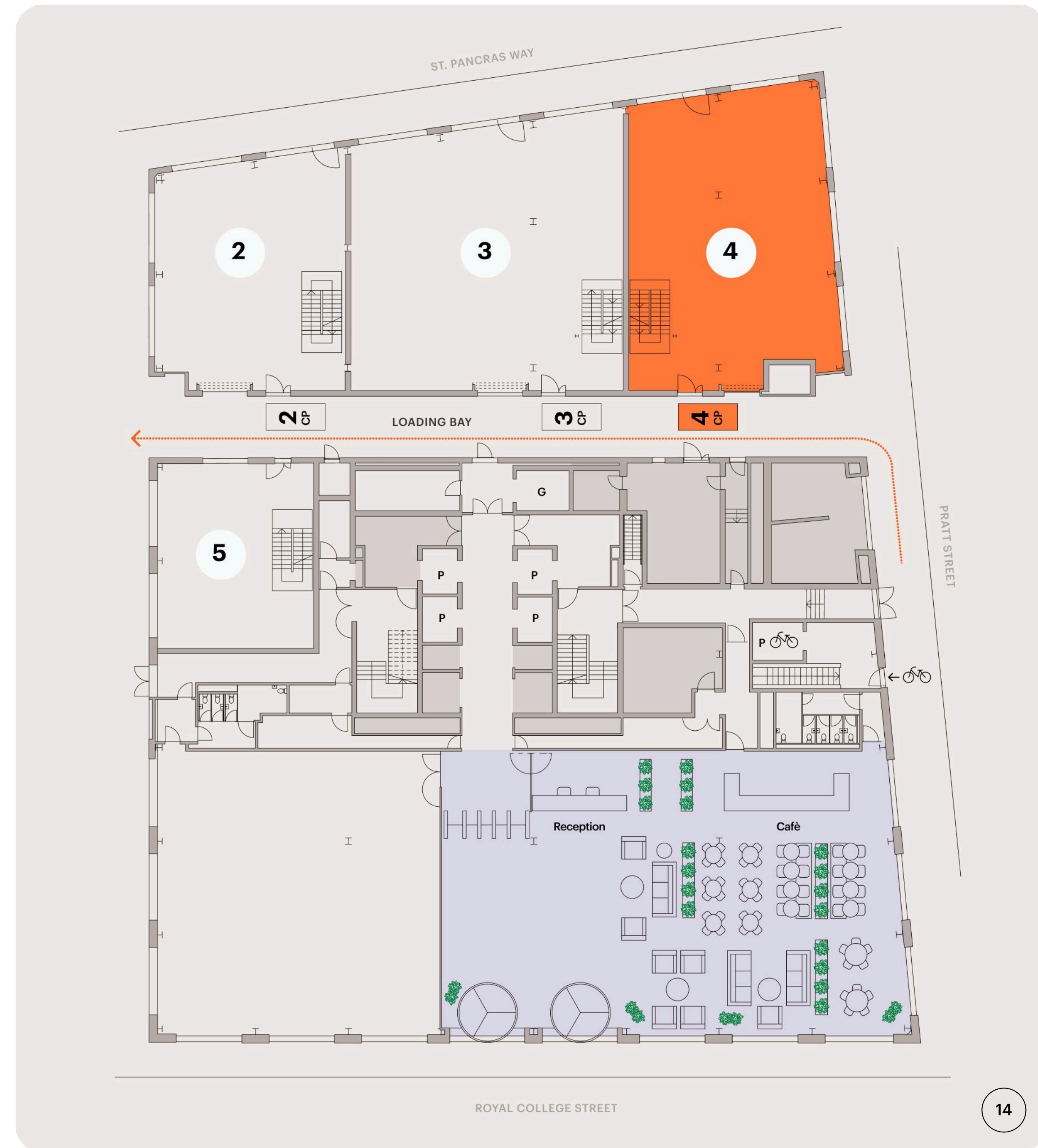

Maker unit Floorplan

5

Floor to ceiling heights:
(floor to underside of structure)

Ground: 3.15 m
Basement: 4.78 m

| Unit | sq ft |
|---|--------------|
| <input type="radio"/> Unit 2 | 4,250 |
| <input type="radio"/> Unit 3 | 8,729 |
| <input type="radio"/> Unit 4 | 6,945 |
| <input checked="" type="radio"/> Unit 5: | |
| Ground | 1,102 |
| Basement | 1,863 |
| Total: | 2,965 |

- 01 Introduction
- 02 Location
- 03 Maker space**
- 04 Contact

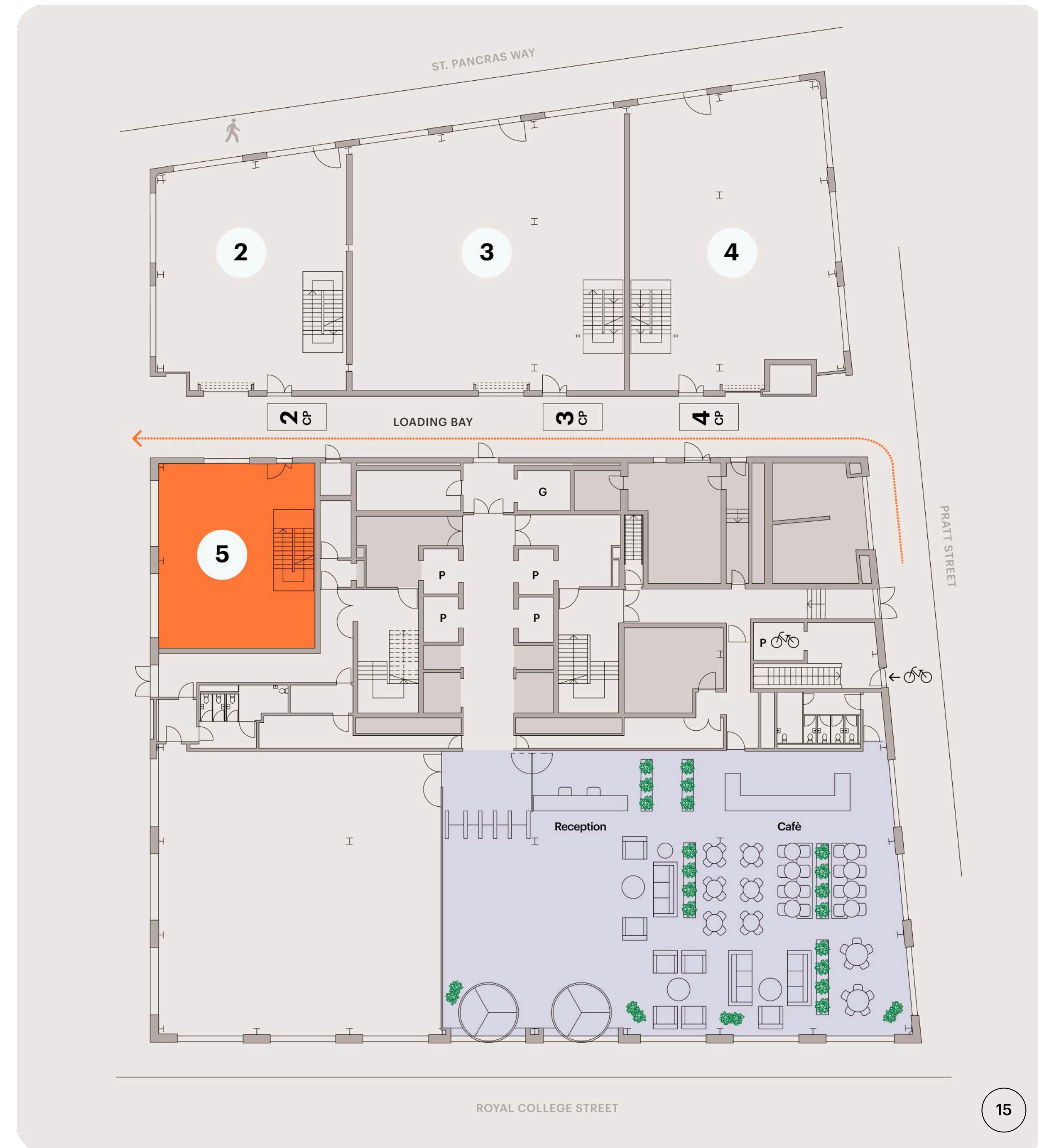

For further information

CBRE

Richard Howard
07764 810 217
Richard.Howard@cbre.com

Georgina Willoughby
07788 706 031
Georgina.Willoughby@cbre.com

Bertie Berry
07345 995 523
Bertie.Berry@cbre.com

RX
LONDON

Alfie John
07377 855 814
Alfie.John@rx.london

Jordan Adair
07880 552 710
Jordan.Adair@rx.london

Amelia Royds
07984 888 063
Amelia.Royds@rx.london

**St. Pancras
Campus.**

100 Royal College St. NW1 0TH

A development by: **W • R E**

